



CLAYBROOK

Specification Sheet

Ellipse 1680

Free standing bath
H31305

1680 mm X 800 mm X 500 mm (66.14 " X 31.5 " X 19.69 ")

Available in various reconstituted stone colours.

Please order Chrome/MarbleForm pop up waste separately.



Mould Code	Description	Available Colours		
H31305	Reconstituted stone bath with overflow	Dover White (DW)	Mist (MI)	Pearl (PE)
		Dune (DU)	Sahara (HA)	Bahia (HB)
		Barley (BA)	Fog (FG)	Taupe (TA)
		Studio (ST)	Armory Grey (AG)	Sable (SA)
		Night Sky (NS)		

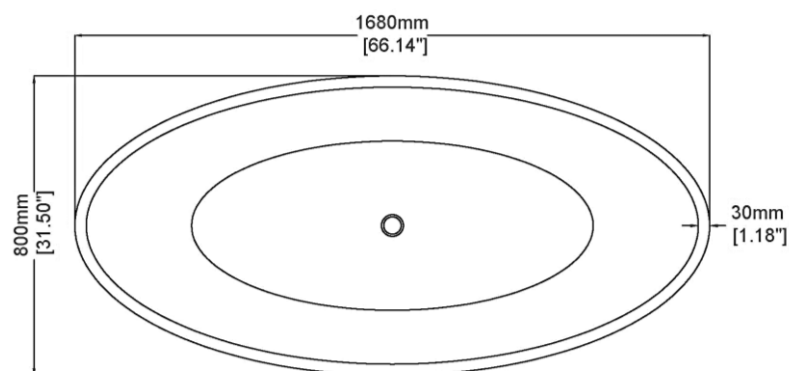

Technical Information		
Bath weight	175 kg	/ 386 lbs
Weight with water	475 kg	/ 1047 lbs
Capacity	300 L	/ 79.2 US gal
Water depth to overflow	391 mm	/ 15.39 \"

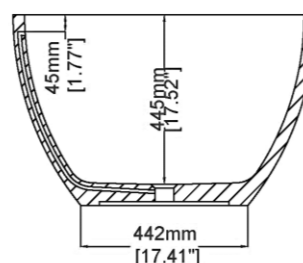
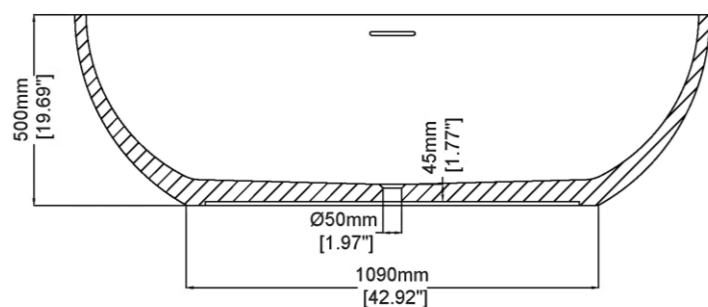

* All measurements are subject to change and variation.

* This specification sheet should not be used as an installation guide. Please contact Claybrook for CAD drawings.